

TFS UNIT DIMENSIONS

TFS / Sizes B-E

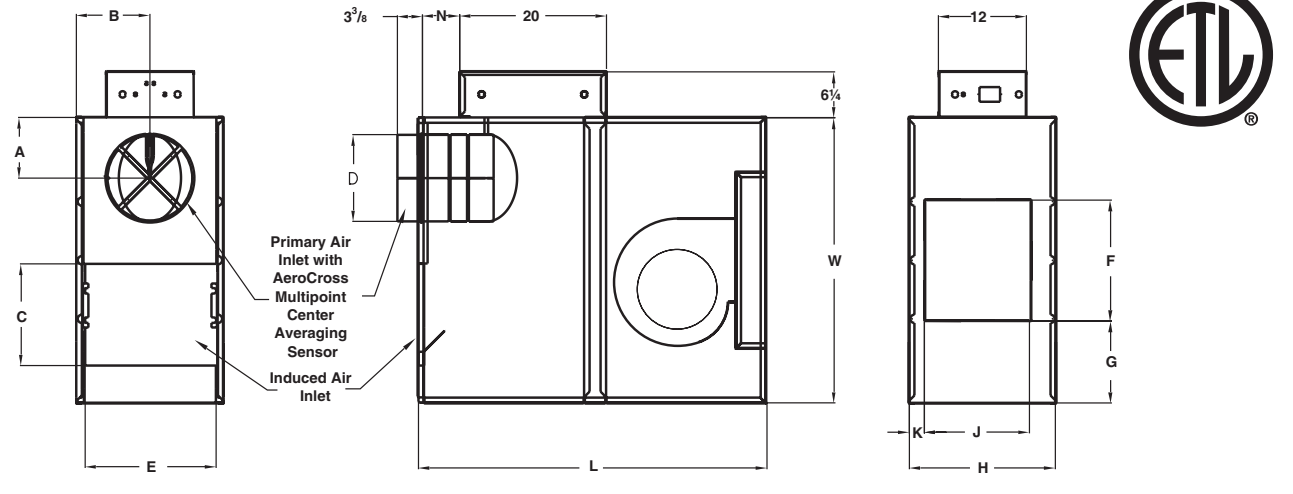

TFS Series Unit															
Size	Unit	A	B	C	D	E	F	G	H	J	K	L	N	W	Filter Size
B	6	6	8	12 1/2	5 7/8	14 1/4	14 1/8	11 1/2	16	11 1/8	2 1/4	43	2 7/8	37	16 x 14
	8	7 7/8			2 7/8										
	10	9 7/8			4 7/8										
	12	11 7/8			4 7/8										
C	6	6	8	12 1/2	5 7/8	14 1/4	14 1/8	11 1/2	16	11 1/8	2 1/4	43	2 7/8	37	16 x 14
	8	7 7/8			2 7/8										
	10	9 7/8			4 7/8										
	12	11 7/8			4 7/8										
D	10	7	10	12	9 7/8	18 1/4	16 1/2	11 1/4	20	14 5/8	2	47 1/2	4 7/8	39	14 x 18
	12	8			11 7/8								4 7/8		
	14	10			13 7/8								6 7/8		
	16	11			15 7/8								6 7/8		
E	12	8	10	12	11 7/8	18 1/4	16 1/2	11 1/4	20	14 5/8	2	47 1/2	4 7/8	39	14 x 18
	14	10			13 7/8								6 7/8		
	16	11			15 7/8								6 7/8		

DIMENSIONS

fan powered terminals

HOT WATER COIL SECTION

STANDARD FEATURES

- ½" copper tubes
- Aluminum ripple fins
- Connections: Male solder 5/8" for both 1- and 2-row. Left or right hand connections.
- Galvanized steel casing
- Flanged duct connection
- Coil is installed at discharge of unit

COIL ROWS

- 1-Row
- 2-Row

SUPPLY VOLTAGE

- 120V, 1 ph, 60 Hz.
- 208/240V, 1 ph, 60 Hz.
- 277V, 1 ph, 60 Hz.

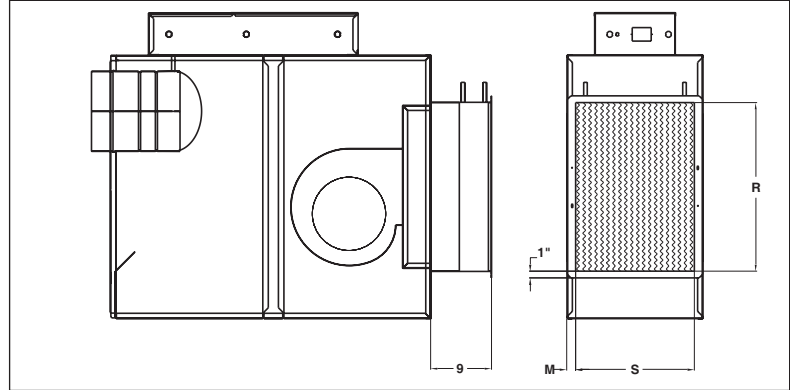

Hot Water Coil Section (Discharge Mounted)				
Unit Size	M (1-Row)	M (2-Row)	R	S
B, C	1	1	20½	12½
D, E	1	1¼	25	17½

Note: R and S are inside dimensions

ELECTRIC COIL SECTION

STANDARD FEATURES

- Auto reset thermal cutouts (one per element)
- 80/20 Nickel chrome heating elements
- Magnetic contactors, where required, on pneumatic units
- Airflow safety switch
- Line terminal block (277/1Ø, 208/240/3Ø, or 480/3Ø 4 wire)
- Flanged connection
- Control transformer for DDC or Analog electronic controls
- Pneumatic electric switch for pneumatic parallel fan terminals only
- Fan relay for DDC fan terminals

- Magnetic contactor per step on terminals with DDC or analog electronic controls

OPTIONS

- Interlocking disconnect
- Main power supply fuses
- Mercury contactors
- Manual reset thermal cutout
- Dust-tight construction
- Optional Lynergy Comfort Controlled SSR Electric Heat available

SUPPLY VOLTAGE

- 208V, 1 ph, 60 Hz.
- 240V, 1 ph, 60 Hz.
- 277V, 1 ph, 60 Hz.
- 208V, 3 ph, 60 Hz.
- 480V, 3 ph, 60 Hz. (4 wire wye only)

Electric Coil Section (Discharge Mounted)				
Unit Size	U	R	S	T
B, C	11¾	14½	11½	2¾
D, E	11	17	15	3⅞

Note: R and S are inside dimensions

See Electric Heat Coils in Section 0 for more information

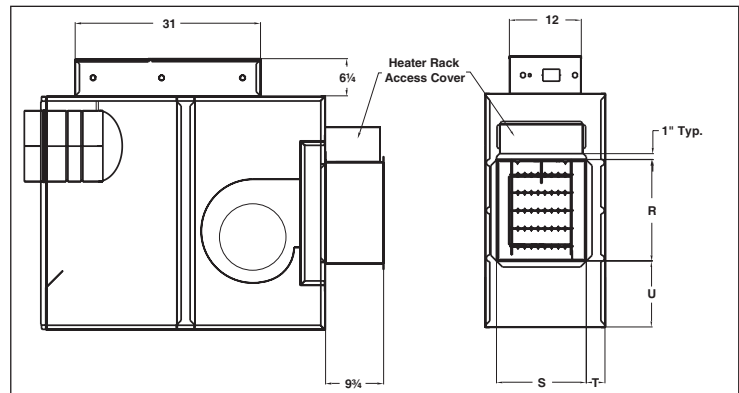

ADDITIONAL ACCESSORIES

(OPTIONAL)

- Induced air filter, 1" thick disposable construction type
- Fan disconnect switch (not available on units with optional electric coils)
- 1" Liner
- Fibre-Free Liner
- SteriLoc Liner
- EcoShield liner
- Fan unit fusing
- Hanger brackets
- Camlocks on fan access door

Electrical Data				
Unit Size	Motor HP	120V	208/240V	277V
		FLA	FLA	FLA
B	1/6	2.3	0.9	0.8
C	1/4	4.0	1.8	1.4
D	1/3	8.5	3.6	3.0
E	¾	8.6	4.2	4.5

All motors are single phase, 60(Hz).

FLA = Full Load Amperage, as tested in accordance with UL 1995

All fan motors are same voltage as electric coil (when supplied), with

exception that 277V motors are used with 480V 3 Phase coils

(four wire wye)

For ECM electrical data see page N27